

# **Caring for your new bath and shower**

Thank you for choosing Bath Fitter®.

Please read the following information carefully. With just a little care and proper maintenance, your new bath and shower will provide many years of trouble-free service.



# Caring for Your New Bath & Shower

## **CLEANING**

Harsh scrubbing or prolonged soaking will not be necessary. Avoid harsh chemicals, disinfectants, and chemical drain cleaners. The use of unapproved cleaners on Bath Fitter® acrylic tubs, walls, showers, and other acrylic products may cause serious damage and void your warranty. It is important that you **ONLY** use approved cleaners. Always rinse any cleaning product off tub and wall surfaces immediately. Cleaners should not be allowed to remain on the acrylic surfaces for any length of time. It is recommended to rinse soap residue from your bath, wall, shower, or other Bath Fitter® acrylic products after each use. Regular cleaning will help keep your new unit looking great for years to come.

## **SILICONE CARE:**

Allow the silicone on your new BATH FITTER® products to set and cure properly. Wait 24 hours before manipulating any silicone joints and refrain from cleaning them for the first five days. Thereafter, we recommend that you remove excess water from all surfaces with a towel or squeegee after each use.

## **TIPS**

- An environmentally friendly solution of water and white vinegar will also do a great job eliminating mildew on silicone and is cost effective.
- Cleaning the silicone regularly with a 50/50 mix of water and regular chlorine bleach will help kill any germs and/or bacteria lying on the surface.

## **TOBACCO:**

Tobacco smoke in close proximity to your Bath Fitter® bathtub and wall system may discolor the product and is **NOT** recommended.

## **SLIP-RESISTANT:**

If your new BATH FITTER® tub or shower base has been treated with a slip-resistant coating, we recommend it be recoated periodically to maintain its effectiveness.

## **IMPORTANT:**

***CAUTION - WET, SOAPY SURFACES CAN BE SLIPPERY. PLEASE BE EXTREMELY CAREFUL WHEN BATHING OR TAKING A SHOWER.***

# Plumbing & Valve Information

## MOEN® MCORE® VALVE

Your Moen® MCORE® valve maintains constant balance between hot and cold water for total comfort. This valve includes adjustable water volume to suit your personal preferences, a \*Temperature Limit Stop as a safety feature, and a Temperature Memory Feature.

The MCORE® valve operates by pulling the knob out to control water flow. Once the knob is pulled out to turn the water on, it is then rotated to select a temperature setting. Turn the valve handle clockwise for hot, counterclockwise for cold, or set it in the middle for a mix of both. To turn the water off, simply push the knob straight in. The next time you pull the knob out to use the faucet, the temperature setting will be the same as it was when you last used it.

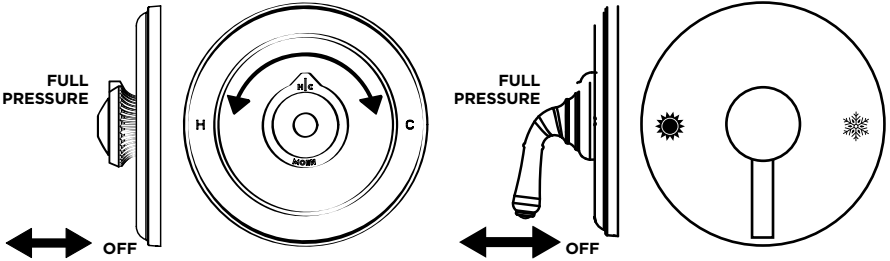

## MOEN® POSITEMP® VALVE

Your Moen® Positemp® valve maintains a constant balance between hot and cold water for total comfort. For added safety, this valve includes a \*Temperature Limit Stop.

The Positemp® valve operates by turning the handle counterclockwise to start the water flow. To change the water temperature to a higher (hotter) temperature, keep turning the handle counterclockwise until you reach your desired temperature. To turn the faucet off, turn the handle clockwise all the way back, until water flow stops.

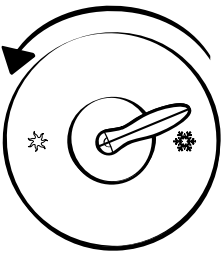

*\*Temperature Limit Stop allows you to control the degree of the water's heat.*

## DIVERTER OPERATION WITH HANDHELD INSTALLED

### Moen

For the Moen® diverter, turn the diverter valve “counterclockwise” to turn on the handheld function – turn it back for regular shower head use.

### Delta

For the Delta® diverter, pull the diverter knob out to turn on the handheld function – push it in for regular showerhead use.

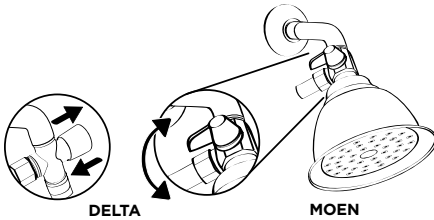

## MOEN 3 FUNCTION TRIM KIT M-CORE

For the Moen® 3-function valve, the diverter can change the direction of water flow from:

1. The shower head,
2. The handheld shower head,
3. or a combination of both.

The valve turns the water on and changes the water temperature.

Please refer to Moen Posi-temp & M-Core Series 3 valves for more details.

### **NOTE:**

*If for any reason your water temperature is not satisfactory, DO NOT attempt to change the settings yourself. Please call Bath Fitter® to have a technician stop by to adjust it.*

*Water pressure: If you have changed the valve/tap system to a newer model (regardless if it is from Bath Fitter® or not), you may notice that the water pressure feels different. This is because all valves now have a “water-saver” feature built into them.*

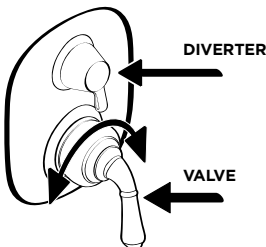

# Drain

## TO CLEAN THE DRAIN

If you notice that water takes longer than usual to drain from the tub, we recommend that you check for any hair or debris caught in the pop-up stopper. To remove the pop-up stopper, simply follow these easy instructions.

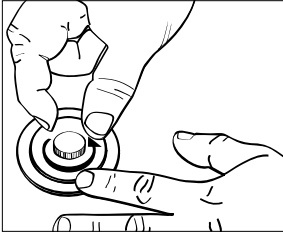

**FIGURE 1**

Hold the stopper and turn the cap counterclockwise.

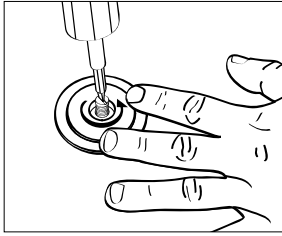

**FIGURE 2**

Use a slotted screwdriver to turn the brass screw counterclockwise.

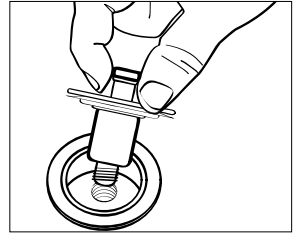

**FIGURE 3**

Pull out the stopper, remove any hair or debris from the drain, then re-install the stopper.

## UN-CLOGGING DRAIN

### **PLEASE NOTE:**

*The use of any chemical drain “plungers” such as Drano, Liquid Plumber etc... could result in irreparable damage to the acrylic surface and will void the warranty.*

*To clear a clogged drain, remove the pop-up stopper. If the stopper is not clogged with hair, fill the bottom of the bathtub with approximately 1 inch of water and use a plunger. If there is not enough suction to clear away the clog (because air is passing through the overflow), remove the overflow cover and stuff a plastic bag into the overflow opening to block the flow of air. Continue to use the plunger. When done be sure to remove the plastic bag and reinstall the overflow cover.*

*If the above steps do not unclog your drain, Bath Fitter® recommends another low-cost, natural solution. Remove the stopper and pour equal parts baking soda and white vinegar into the drain. Next, pour hot water into the drain. Re-install the pop-up stopper.*

*If these methods fail, it may be necessary to call in a plumber. Be sure to inform the plumber that use of unapproved chemical cleaners could cause irreparable damage to your Bath Fitter® products and void the warranty.*

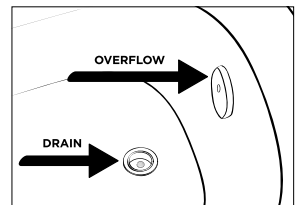

# Drain Grab Bar

## GRAB BAR BEAUTY RINGS

Bath Fitter® grab bars have beauty rings covering the wall anchors. These rings are for aesthetic purposes and not meant to be tightly fixed to the wall anchors. A certain amount of movement in these beauty rings is normal.

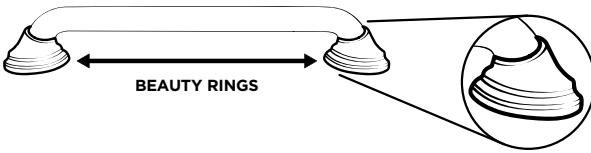

# Tub & Shower Door Information

## PROPER CLOSE POSITION

The design of the Bath Fitter® tub and shower doors requires that the inner door be closed, as shown, to prevent water from the showerhead spraying between the glass panels and onto your bathroom floor.

### CORRECT

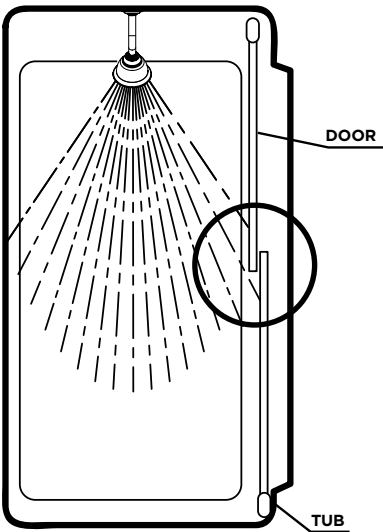

(OVERHEAD VIEW)

### INCORRECT

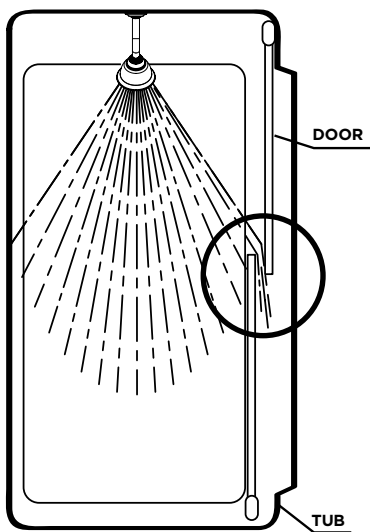

(OVERHEAD VIEW)



[BATHFITTER.COM](http://BATHFITTER.COM)

FOR AN UPDATED ELECTRONIC VERSION OF THIS DOCUMENT  
VISIT OUR WEBSITE [BATHFITTER.COM](http://BATHFITTER.COM)